

Hydraulic Cylinders

TRITORC cylinders operate with a maximum pressure of 700 Bar. With Single and Double acting ranges TRITORC cylinders show versatility in operational requirements and fulfill the needs of the user.

All Single Acting Cylinders are spring return and Double Acting Cylinders are oil return.



Single-Acting Hollow Hydraulic Cylinder



Capacity: **13-95 ton**
Stroke: **42-155 mm**
Max. Pressure: **700 bar**

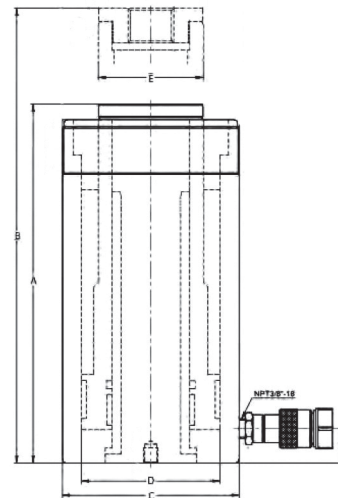

Cylinder Capacity	Stroke	Model Number	Oil Capacity	Collapsed Height	Extend Height	Outside Dia.	Cylinder Bore Dia.	Plunger Dia. (Thread)	Weight
				A	B	C	D	E	
ton (kN)	(mm)		(cm ³)	(mm)	(mm)	(mm)	(mm)	(mm)	(Kg)
13 (125)	42	SAHH 130-42	76	130	172	76	55	35.5	3.4
	76	SAHH 130-76	138	184	260	76	55	35.5	5.2
20 (215)	49	SAHH 200-49	174	162	211	101	77	54.5	8.2
	155	SAHH 200-155	550	306	461	101	77	54.5	15
30 (326)	64	SAHH 300-64	307	180	244	115	90	64.5	11.5
	155	SAHH 300-155	744	330	485	115	90	64.5	21.5
60 (576)	76	SAHH 600-76	640	247	323	159	125	94.5	28.2
	153	SAHH 600-153	1278	323	476	159	125	94.5	35.5
95 (931)	76	SAHH 1000-76	1028	254	330	212	165	125	63.5